

Zesumme renovéieren

Driving energy-efficient renovation forward

How can you find out the cost of insulation?

Ask for a quote from a specialist company. Below you will find a summary of the requirements that your contractor must meet in its offer to ensure you are eligible for Klimabonus state subsidies.

Insulation of floor slab eligible for Klimabonus subsidies

Minimum insulation thickness: 12 cm

if its thermal conductivity is **0.035 W(mK)**

The minimum insulation thickness depends on the thermal conductivity of the material and may therefore vary as follows:

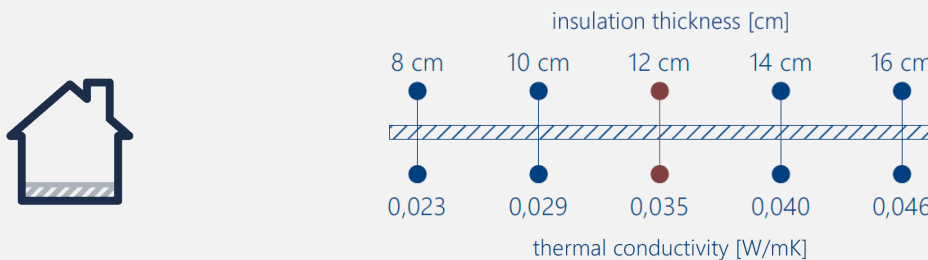

Requirements related to the choice of insulation material

Fossil-based insulation material

- The environmental index I_{eco12} is less than 50 UI6/m² (except for the insulation of building elements in contact with the ground)
- Where a request for an “Agreement in Principle” was submitted since 01/01/2024, the fossil-based insulation must be made from at least 50% recycled materials.

Mineral insulation material

- It must be made of 100% mineral materials (including plaster)
- The environmental index I_{eco12} is 23.7 UI6/m² at most
- The mineral insulation is **fixed mainly** in a removable way (with the exception of the plaster).

Ecological insulation material

- It must be made of 100% renewable materials (including plaster)
- The environmental index I_{eco12} is 23.7 UI6/m² at most
- The ecological insulation is **fixed solely** in a removable way (with the exception of the plaster).

Additional requirements to qualify for Klimabonus state subsidies

Before the renovation work can be carried out, the Environmental Agency must give its "Agreement in principle"

- on the basis of energy-efficiency recommendations by a certified energy advisor, or
- for a single construction element, based on support from a certified energy advisor or an approved craftsman.

Good to know

Additional bonus to Klimabonus subsidies: greatly reduced VAT rate of 3%

For renovation work, you are charged a reduced VAT rate of 3% instead of the usual 16%, up to a total tax reduction amount of €50,000. The contractor carrying out the work applies the extremely reduced rate directly to construction or renovation work.

The residential building must be older than 10 years.

For all the prerequisites, please go to guichet.lu



Klima-Agence G.I.E.
2, Circuit de la Foire Internationale
L-1347 Luxembourg
T. +352 40 66 58
R.C.S. Luxembourg C84
info@klima-agence.lu



Pour plus d'informations sur le projet pilote
Zesumme renovéieren, scannez le code QR.